

Pasve pH with pneumatic actuator

PASVE pHF
(Flange type)

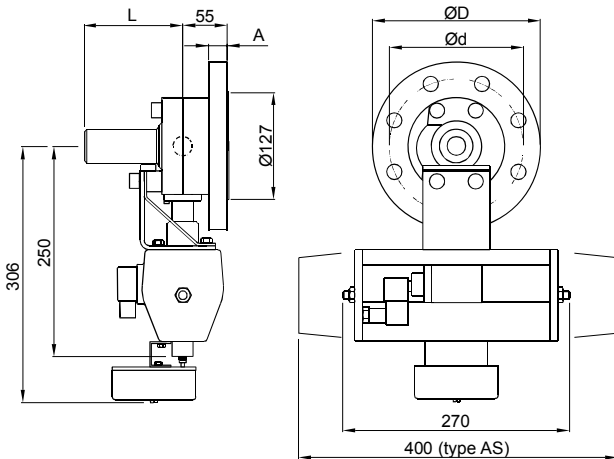

PASVE pHC
(Welded on container or)



PASVE pHP
(Shape the body to be suitable to the pipe, welded)

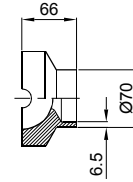

PASVE pHF

FLANGE		ØD	Ød	A
Code	Type			
A	ANSI 3" 150 lb	191	152.4	22
B	ANSI 3" 300 lb	210	168.3	27
C	DN100 PN40	220	180	26
D	DN80 PN40	200	160	22
E	JIS 10K 80	185	150	20
F	JIS 40K 80	210	170	30

PASVE pHB
(Welded on container or vertical pipe, body 15°)

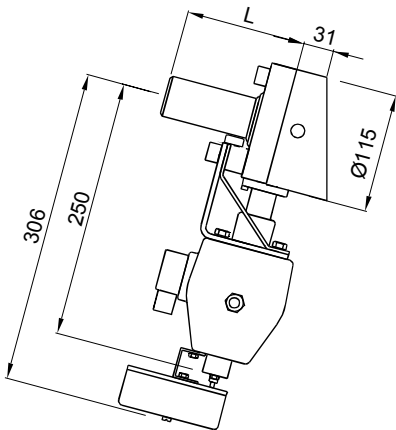

L depends on the sensor type

Dimensions (in mm)

PASVE pHD

FLANGE		W	ØD	H
Code	Type			
H	ANSI 1" 150 lbs	55	108	48
J	ANSI 1" 300 lbs	55	124	48
U	ANSI 2" 150 lbs	68	153	76
V	ANSI 2" 300 lbs	68	165	76
G	DN25 PN40	55	115	48
T	DN50 PN40	68	165	76

PASVE pHT
(Flow-through, threaded connection)

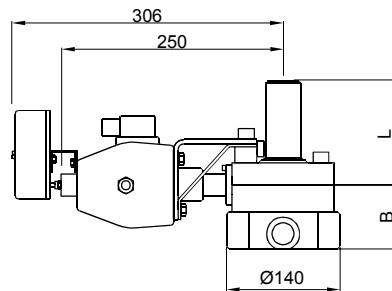

PASVE pHD
(Flow through, flange connection)

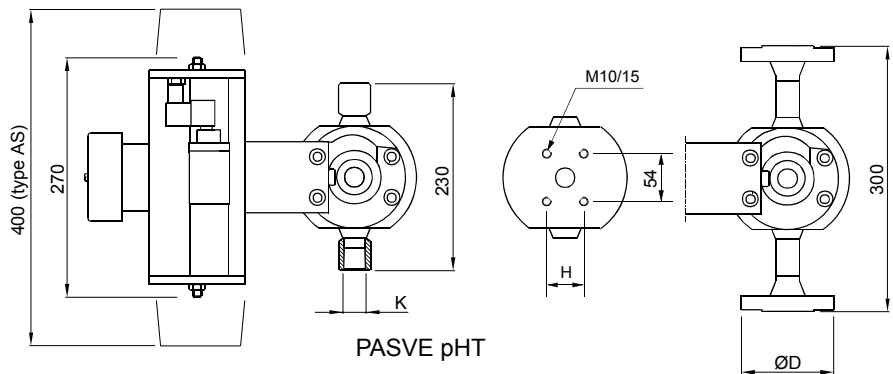
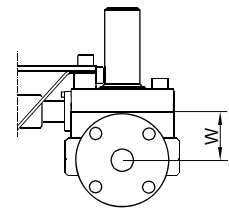

PASVE pHT

THREAD		B	H
Code	Type (dim.K)		
2	1" - NPT	77	48
4	1.5" - NPT	92	64
5	2" - NPT	104	76

Surface temperature

Ambient temperature °C	Temperature class
70	T6
85	T5
120	T4

European Directive Information

ATEX directive (94/9/EC)
Satron Instruments Inc. complies with the ATEX directive.

European Pressure Equipment Directive (PED) (97/23/EC)
- Sound Engineering Practice

European Certification

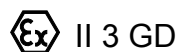

Sensor connection

Standard sensor connection PG13.5 / length 120 mm

Code dimension R

- S R < 30 mm
- M R < 20 mm
- L R < 10 mm

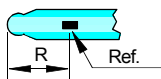

Special sensor connection types

Code Sensor

- A1 Satron S508
- A2 in-line Satron S508 (manual only)
- B1 Broadley-James Dynaprobe II
- B2 Broadley-James S410
- B3 Broadley-James DynaProbe ST856
- C1 Honeywell Durafet II
- C2 Honeywell Meredian II
- E1 Endress+Hauser CPF81
- E2 Endress+Hauser CPF81 -flat glass
- F1 Foxboro 871A
- F2 Foxboro 871pH
- F3 Foxboro PH10-3
- F4 Foxboro PH10-2
- G1 Lange (GLI) pHD1P
- G2 Lange (GLI) DPD1P1
- O2 Orbisphere (31110)
- R1 Rosemount 389
- R2 Rosemount 385+
- R4 Rosemount 396TUpH
- R6 Rosemount 396P
- R9 Rosemount 3300HT/HTVP
- T1 ABB TB556 (38 mm insertion depth), flat glass
- T2 ABB TB557
- T3 ABB TB564
- T4 ABB TB561
- T5 in-line ABB TB564 (manual only)
- T6 in-line ABB TB561 (manual only)
- T7 ABB TB556 (28 mm insertion depth), flat glass
- Y1 Orbisphere FU20 - - NPT

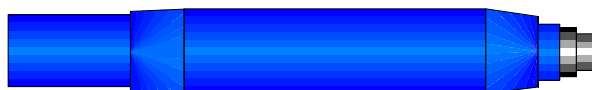

OPERATING POSITIONS

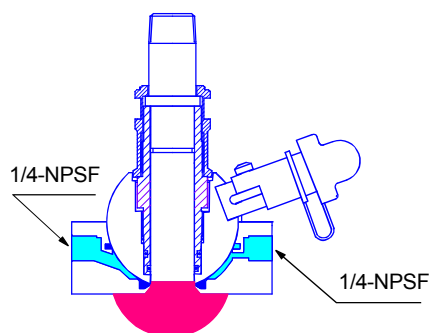

Measuring position
Sensor in measurement. Valve's and sensor's water cooling through flushing channel.

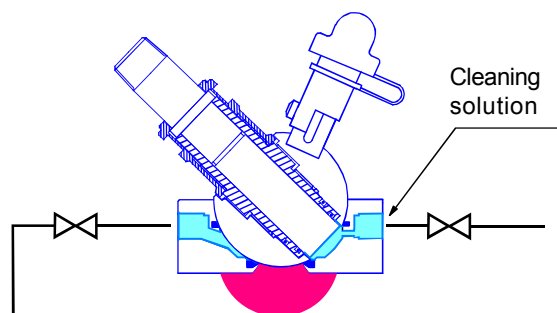

Servicing and calibration position
Sensor turned to cleaning, calibrating and protective position without stopping the process.

PASVE® pH Installation in horizontal pipe

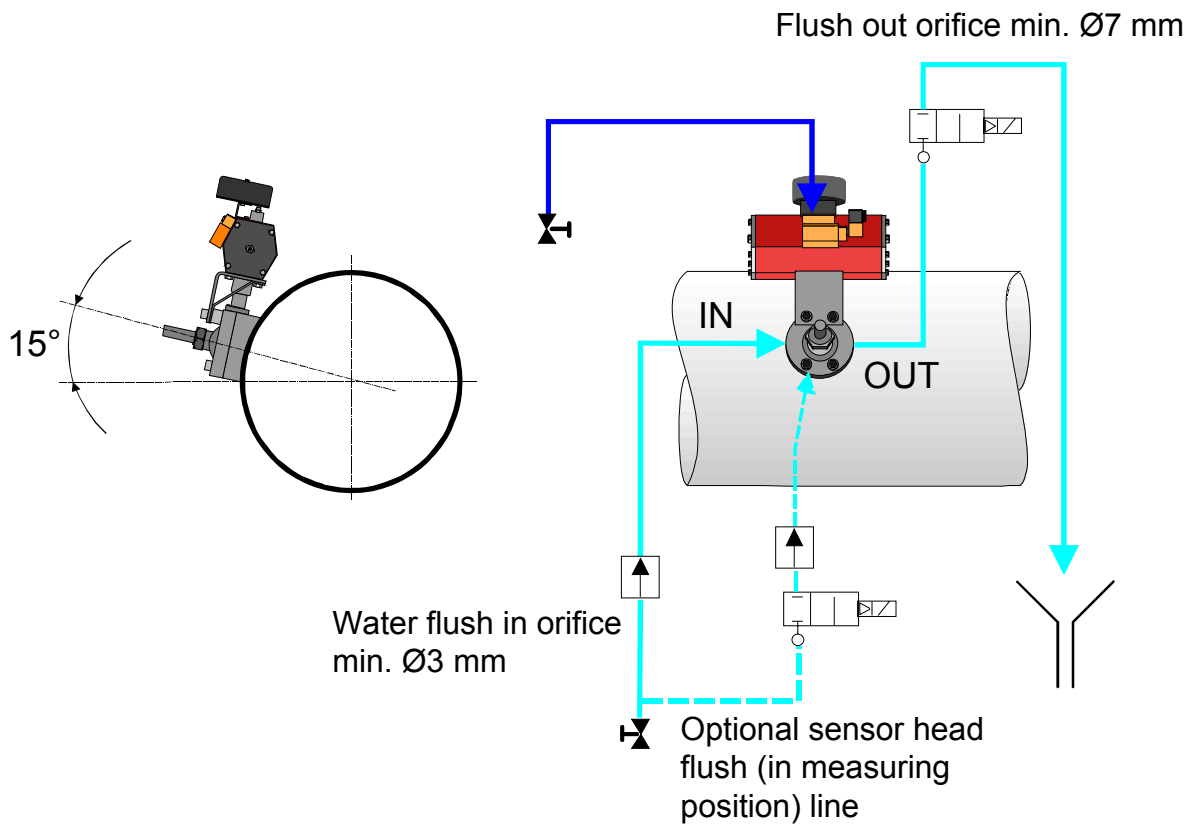

PASVE® pH Installation in vertical pipe

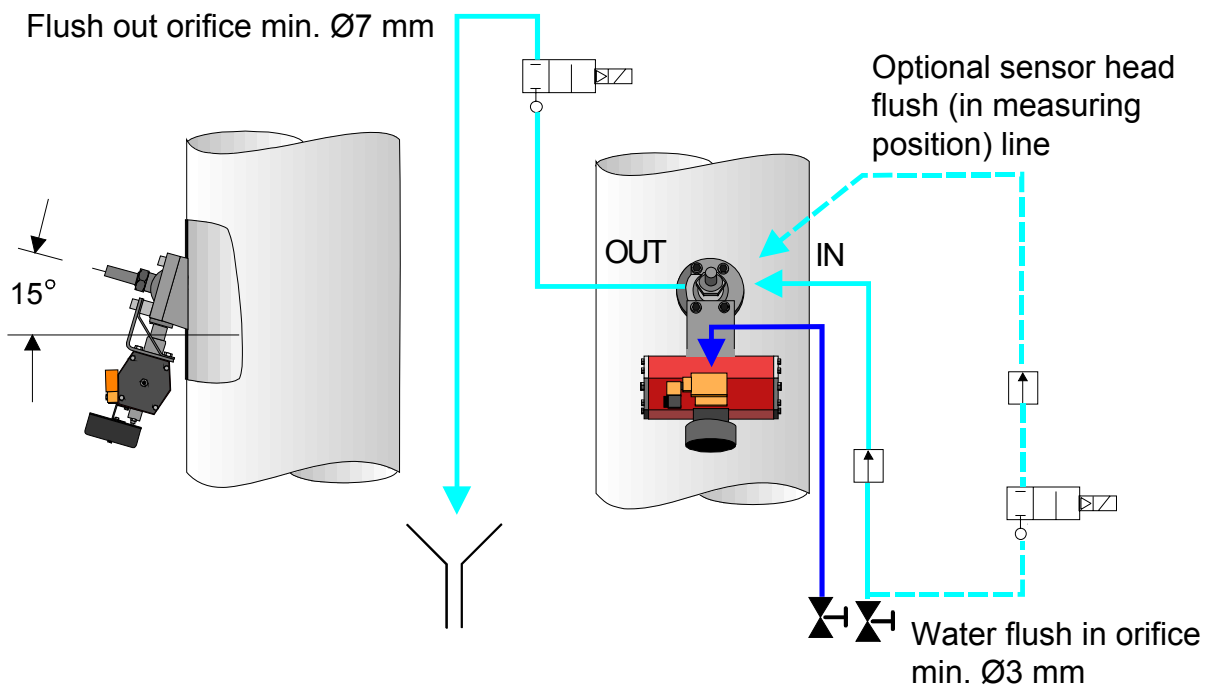

We reserve the right for technical modifications without prior notice.

Hastelloy is the registered trademark of Haynes International.

Pasve is the registered trademark of Satron Instruments Inc.