

Overview Probes VA(T)40 ZG2 and ZG5

Vortex Flow Sensors + Accessories

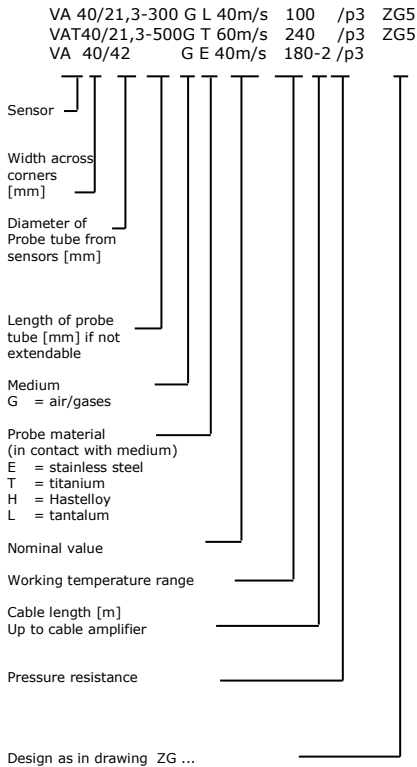

TÜV qualification tested
for continuous measurement of
exhaust flow rate in the case of
officially approved outgoing air
plants, garbage incinerating
plants and industrial furnaces
according to TA-Luft, 13th and
17th BImSchV.



Probes VA as in drawing 5, also available in protective system Ex

	Article No.
VA 40/21,3-300 GE 40m/s 100/p3 ZG5	B009/500
VA 40/21,3-300 GH 40m/s 100/p3 ZG5	B009/506
VA 40/21,3-300 GT 40m/s 100/p3 ZG5	B009/510
VA 40/21,3-300 GL 40m/s 100/p3 ZG5*	B009/528
VA 40/21,3-300 GE 40m/s 180/p3 ZG5	B009/514
VA 40/21,3-300 GH 40m/s 180/p3 ZG5	B009/520
VA 40/21,3-300 GT 40m/s 180/p3 ZG5	B009/524
VA 40/21,3-300 GL 40m/s 180/p3 ZG5*	B009/530
VA 40/21,3-300 GE 40m/s 240/p3 ZG5	B009/531
VA 40/21,3-300 GH 40m/s 240/p3 ZG5	B009/532
VA 40/21,3-300 GT 40m/s 240/p3 ZG5	B009/533

* price on request

Probes VAT as in drawing 5 with temperature sensor Pt100 under the sensor cap. Output temperature 4-wire Pt100 or 4 ... 20 mA. t/4 ... 20 mA output 2-wire configured.

	Article No.
VAT 40/21,3-300 GE 40m/s 100/p3 ZG5	B009/550
VAT 40/21,3-300 GH 40m/s 100/p3 ZG5	B009/556
VAT 40/21,3-300 GT 40m/s 100/p3 ZG5	B009/560
VAT 40/21,3-300 GE 40m/s 180/p3 ZG5	B009/564
VAT 40/21,3-300 GH 40m/s 180/p3 ZG5	B009/570
VAT 40/21,3-300 GT 40m/s 180/p3 ZG5	B009/574
VAT 40/21,3-300 GE 40m/s 240/p3 ZG5	B009/579
VAT 40/21,3-300 GH 40m/s 240/p3 ZG5	B009/580
VAT 40/21,3-300 GT 40m/s 240/p3 ZG5	B009/581

Additional price for probe tube length Ø 21,3 mm different than above

	Article No.
Change of the standard installation length	B099/800
Other installation length 'stainless steel' each 100 mm	B099/800-MM
Other installation length 'titanium' each 100 mm	B099/801-MM
Other installation length 'Hastelloy' each 100 mm	B099/802-MM
Other installation length 'tantalum' each 100 mm	B099/803-MM
Maximum admissible lengths	
for probes as in drawing 5 made of stainless steel, Hastelloy or titanium Measure A 300 ... 1500 mm	

Extendable probes

Probes VA as in drawing 2, also available in protective system Ex

	Article No.
VA 40/42 GE 40m/s 100/p3	B009/200
VA 40/42,4 GH 40m/s 100/p3	B009/208
VA 40/42 GT 40m/s 100/p3	B009/212
VA 40/42 GE 40m/s 180-2/p3	B009/216
VA 40/42,2 GH 40m/s 180-2/p3	B009/222
VA 40/42 GT 40m/s 180-2/p3	B009/226
VA 40/42 GE 40m/s 240-2/p3	B009/230
VA 40/42,4 GH 40m/s 240-2/p3	B009/231
VA 40/42 GT 40m/s 240-2/p3	B009/232

Probes VAT as in drawing 2 with temperature sensor Pt100 under the sensor cap. Output temperature 4-wire Pt100

	Article No.
VAT 40/42 GE 40m/s 100/p3	B009/250
VAT 40/42,4 GH 40m/s 100/p3	B009/258
VAT 40/42 GT 40m/s 100/p3	B009/262
VAT 40/42 GE 40m/s 180-2/p3	B009/266
VAT 40/42,4 GH 40m/s 180-2/p3	B009/272
VAT 40/42 GT 40m/s 180-2/p3	B009/276
VAT 40/42 GE 40m/s 240-2/p3	B009/280
VAT 40/42,4 GH 40m/s 240-2/p3	B009/281
VAT 40/42 GT 40m/s 240-2/p3	B009/282
Direction indicator RZ42	B099/957
Direction indicator RZ42.4	B099/958

Options

	Article No.
Nominal value 60 m/s	V_VA_60
Ex design for flow sensors VA as in drawing ZG5, but not VAT...: ATEX category 1/2G (zone 0) Ex ia IIC T6 and category 1/2D (zone 20) Ex ia IIIC TX	VAEX0
Ex design for flow sensors VA as in drawing ZG2, but not VAT...: ATEX category 2G (zone 1) Ex ia IIC T6	VAEX1
Ex design for flow sensors VA, VAT*: ATEX category 3G (zone 2) Ex na IIC T6 and ATEX category 3D (zone 22) Ex tc IIIC TX * with suitable evaluation unit	VAEX2

Length of cable up to cable amplifier for probes as in drawing 2 longer or shorter than 2 m, max. 10 m/3 m for probes for 180 °C / 240 °C

Basic price probes VA and VAT	VAKL
Probe VA / 100 °C each m	VAKL_M100
Probe VA / 240 °C each m	VAKL_M240
Probe VAT / 100 °C each m	VATKL_M100
Probe VAT / 240 °C each m	VATKL_M240

Sonden

Drawing 2

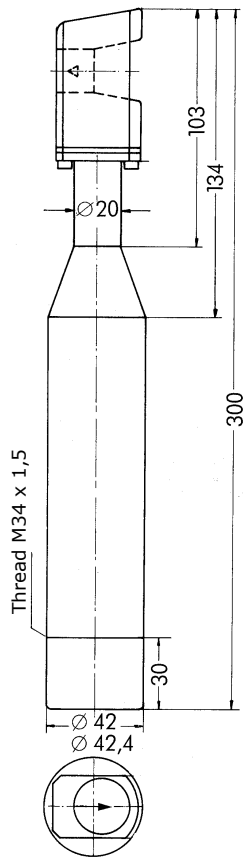

Drawing 5

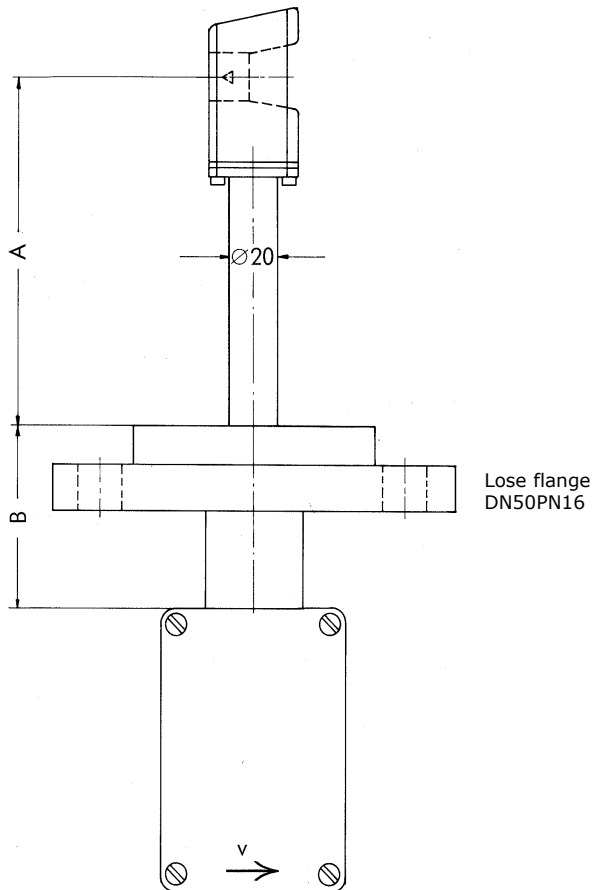

Probe guide pieces SF

SFZ = SF with collet chuck
 SFK = SF mit clamp strap
 SFB = SF with clamping bush

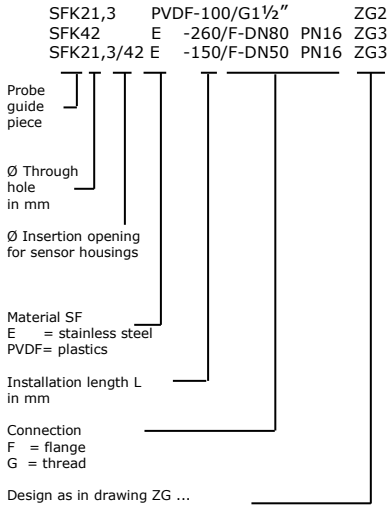

Drawing 1

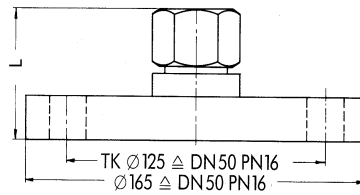

Drawing 2

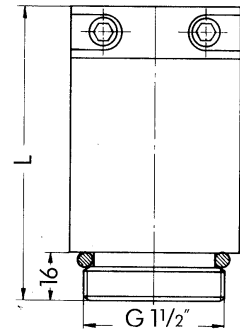

Drawing 3

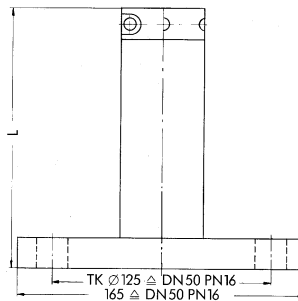

Drawing 5

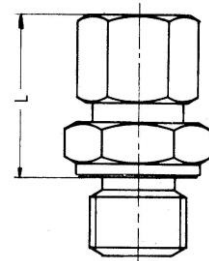

	article no.
SFK 21,3 E- 150/F-DN50 PN16 ZG3 ⁴⁾	B004/304
SFB 21,3 E-70/F-DN50 PN16 ZG1 ³⁾	B004/103
SFB 21,3 E-53/G1½" ZG5 ^{3) 4)}	B004/504
SFB 21,3 E-80/G2" ZG5 ³⁾	B004/505
SFK 21,3 PVDF ¹⁾ -100/G1½" ZG2 ⁵⁾	B004/206
SFZ 21,3 PVDF ¹⁾ -125/F-DN50PN16 ZG3 ³⁾	B004/305
SFK 42 E-260/F-DN50 PN16 ZG3 ²⁾	B004/307
SFK 42 E-260/F-DN80 PN16 ZG3 ²⁾	B004/308
SFZ 42 PVDF ¹⁾ -225/F-DN50 PN16 ZG3 ²⁾	B004/309
SFK 42,4 E-260/F-DN50 PN16 ZG3 ²⁾	B004/310
SFK 42,4 E-260/F-DN80 PN16 ZG3 ²⁾	B004/311
SFZ 42,4 PVDF ¹⁾ -225/F-DN50PN16 ZG3 ²⁾	B004/312
SFK 21,3/42 E-150/F-DN50 PN16 ZG3 ⁵⁾ mit Flansch-Kugelhahn DN50PN16 Kugelhahn ca. 150 mm lang	B004/313
SFK 21,3/42 E-150/F-DN50 PN16 ZG3 ⁵⁾ (ohne Flansch-Kugelhahn DN50PN16)	B004/314

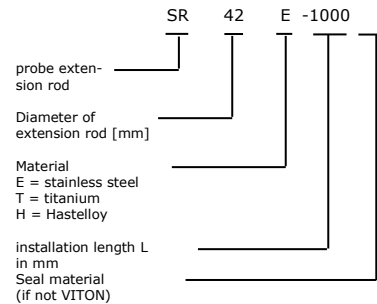

1) for max + 120 °C

Seal material:

- 2) VITON® lip seal
 - 3) TEFLON® clamping bush
 - 4) VITON® O-Ring
 - 5) VITON® O-Ring 2x
- ® DuPont trademark

Probe extensions for probes as in drawing 2	article no.
SR42E-350	B099/510
SR42E-500	B099/511
SR42E-1000	B099/512
SR42,4H-500	B099/513
SR42,4H-1000	B099/514
SR42T-500	B099/515